



KONICA MINOLTA

AccurioLabel 400

SEE THE POTENTIAL OF OUR NEXT GENERATION LABEL PRESS

RETHINK LABEL PRINTING



5-Colour narrow web
digital label press

Giving Shape to Ideas

TECHNICAL SPECIFICATIONS

RETHINK LABEL PRINTING

SYSTEM SPECIFICATIONS

| | |
|-----------------------------------|---|
| Technology | Dry Toner Electrophotography |
| Colour | CMYK, white (optional) |
| Resolution | Main scan: 1,200 dpi (3,600 dpi equivalent) Sub scan: 2,400 dpi (8 bit) |
| Tone scale | 256 steps (8 bit), 16,700,000 colours |
| Printing speed | 39.9 m/min. (CMYK), down to 20 m/min. (CMYK+W), 39.9, 34.2, 30, 20, 15 m/min. depending on media types |
| Web control | Integrated web guide system (BST) on infeed section and rewinder |
| Shaft diameter | 3 inches |
| Paper widths | 165 to 330 mm |
| Max. printed image width (length) | 320 mm |
| Media thickness (weight) | 60 to 250 µm |
| Supported substrates | Paper, PP, PET |
| Machine dimensions (L x W x H) | 7,160 x 1,435 x 1,628 mm 7,360 x 1,538 x 1,905 mm (Pro version) |
| Machine Floor Layout (L x W x H) | 7,930 x 2,130 x 1,628 mm 8,130 x 2,145 x 1,905 mm (Pro version) |
| Machine weight | 2,920 kg 3,520 kg (Pro version) |
| Max. roll diameter | 1,000 mm (unwinder and rewinder) |

- Options**
- Corona treater
 - Unwind unit for lamination
 - Drawer dusty cleaner -double sides

CONTROLLER

| | |
|-----------------------------------|---------|
| Konica Minolta Controller | IC-611 |
| Kodak (Creo) Controller, optional | IC-320L |

- The support and availability of the listed specifications and functionalities varies depending on operating systems, applications and network protocols as well as network and system configurations.
- The actual life of each consumable will vary depending on use and other printing variables including coverage, size, media type, ambient temperature and humidity.
- Specifications are subject to change without prior notice, please refer to technical documentation for site inspection.
- Konica Minolta does not warrant that any specifications mentioned will be error-free.
- All brand and product names may be registered trademarks or trademarks of their respective holders and are hereby acknowledged.

POWER & AIR SUPPLY

| | |
|-------------------------|--|
| Print engine | 2 x Single Phase 220-230 V, 25A, 50/60Hz |
| RE-101 | 1 x Single Phase 15A, 50/60Hz |
| IQ-520 | 1x 200-240 V, 3 A, Single Phase 50-60 Hz |
| Winders | 1 x 3 Phase 380V,26A,50/60Hz 1 x 3 Phase 380V,39A,50/60Hz (Pro version) |
| Compressed air | 8 bar |
| Environment requirement | Temperature: 18-23 °C Humidity: 40% to 60% RH |

AccurioLabel 400 + ALP 400 Layout

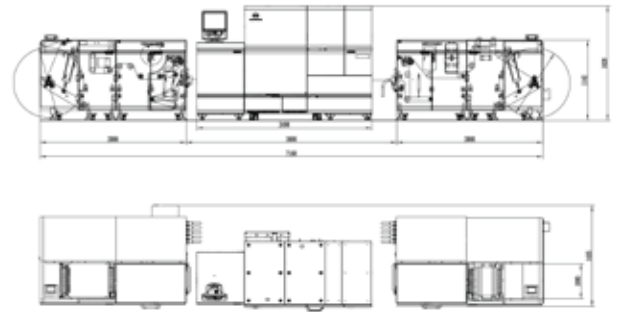

AccurioLabel 400 + ALP 400 Pro Layout

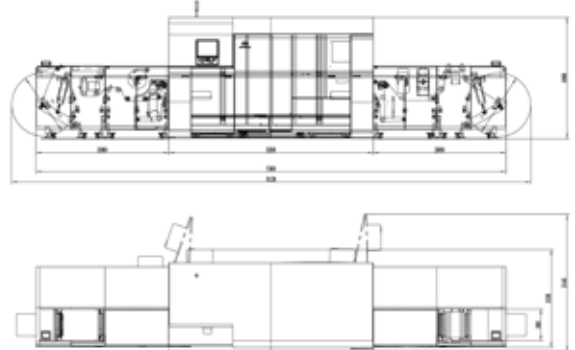

Please scan for more information on
AccurioLabel 400



For the Earth. For the Future.

V0123

Konica Minolta Business Solutions India Pvt. Ltd.

Building No: 8, Tower-C, 10th Floor, DLF Cyber City, Phase-2, Gurugram, Haryana-122002, India
Toll Free No. 1800 2662525 | URL: www.konicaminolta.com | marcom@bin.konicaminolta.in

